

**Paper Feed Unit PB3100/PB3130
Machine Code: D537/D580**

Field Service Manual

September, 2011
Subject to change

TABLE OF CONTENTS

1. Replacement and Adjustment

Exterior Cover.....	3
Rear Cover.....	3
Electrical Components.....	4
Lift Motors.....	4
Upper and Lower Paper Feed Clutches.....	4
Paper Feed Motor.....	5
Main Board.....	6
Feed.....	7
Paper Feed Unit.....	7
Pick-up, Paper Feed and Separation Rollers.....	8
Lift, Paper End, and Relay Sensors.....	8
INDEX.....	11





1. Replacement and Adjustment

Exterior Cover

1

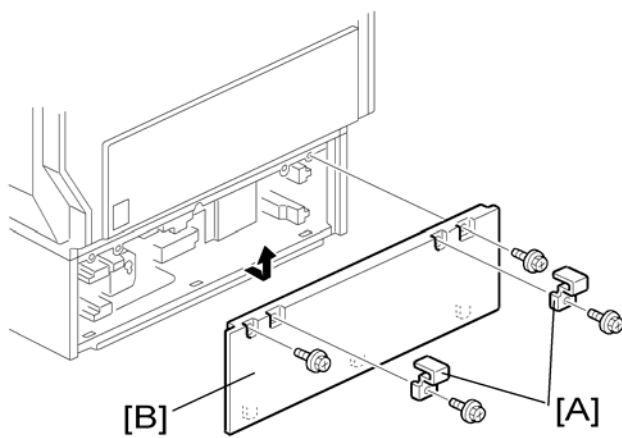
Rear Cover



1. Securing brackets [A] ( x 1 each)
2. Rear cover [B] ( x 2)

Electrical Components

1

Lift Motors

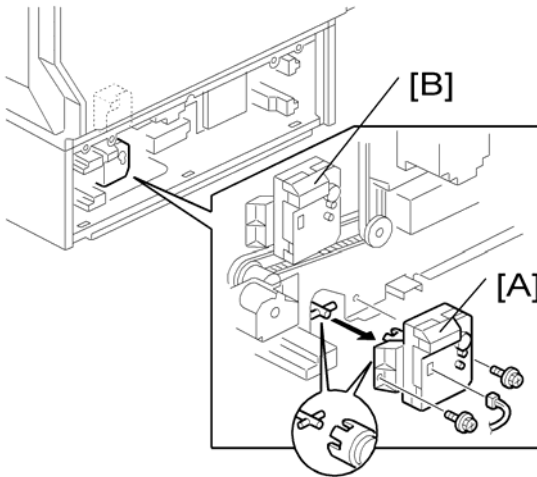

1. Rear cover (🔧 "Rear Cover")
2. Lift motors [A][B] (🔧 x 2, 📦 x 1 each)

Upper and Lower Paper Feed Clutches

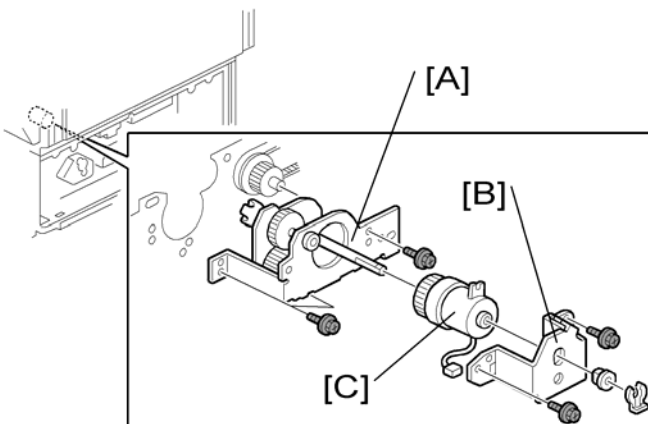

1. Rear cover (🔧 "Rear Cover")
2. Upper paper feed gear unit [A] (🔧 x 3, 📦 x 1)
3. Upper paper feed clutch bracket [B] (🔧 x 1, 📦 x 2, bushing x 1)

4. Upper paper feed clutch [C]

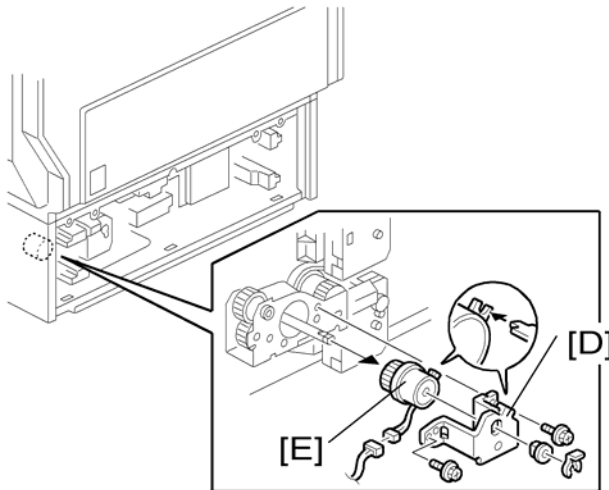

5. Lower paper feed clutch bracket [D] (⚙️ x 1, bushing x 1, 🔩 x 2)

6. Lower paper feed clutch [E] (🔌 x 1)

Paper Feed Motor

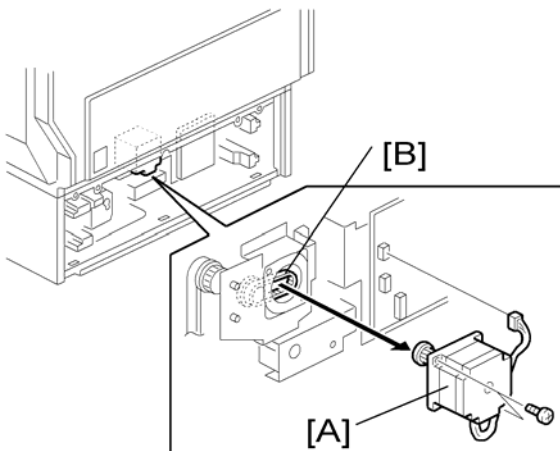

1. Rear cover (🔌 "Rear Cover")

2. Paper feed motor [A] (🔌 x 1, 🔩 x 2)

↓ **Note**

- When installing the paper feed motor, make sure that the gear of the paper feed motor holds the timing belt [B].

1

Main Board

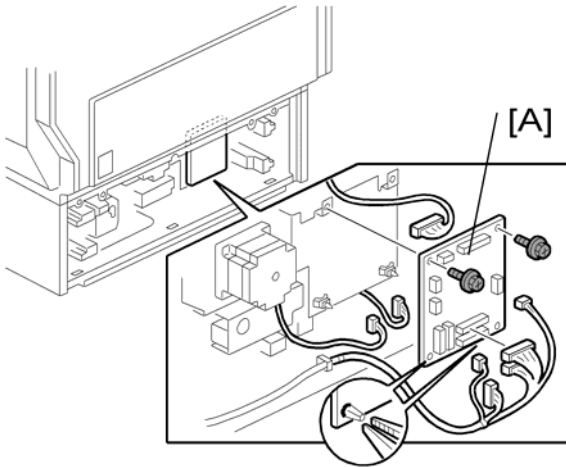



1. Rear cover (Rear Cover)
2. Main board [A] (All s, x 2, snap pin x 2)

Feed

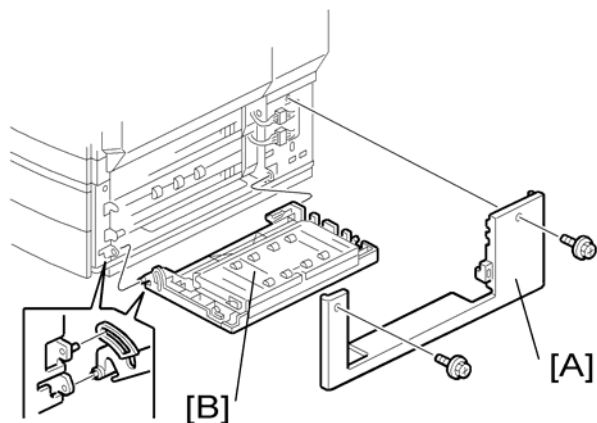

Paper Feed Unit

1

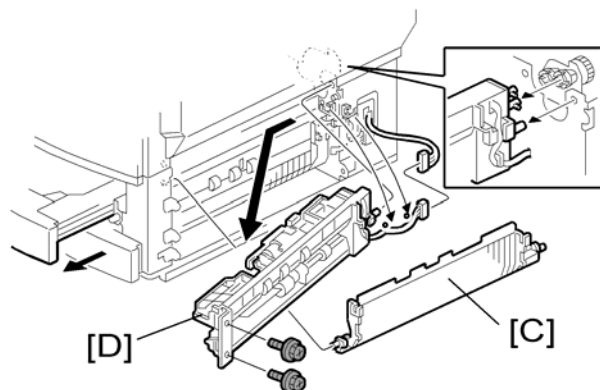

1. Right cover [A] ( x 2)
2. Vertical transport guide [B] of the paper feed unit





3. Pull the tray 3 (or 4).
4. Paper guide [C]
5. Paper feed unit [D] ( x 2,  x 1,  x 2)

When replacing the paper feed unit of tray 4, do the same.

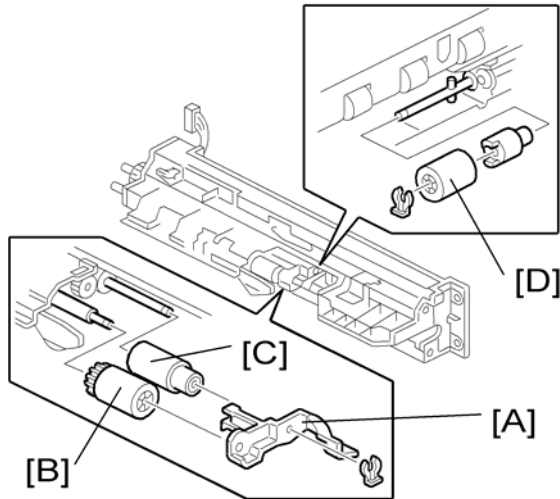
Pick-up, Paper Feed and Separation Rollers



1. Paper feed unit ( "Paper Feed Unit)
2. Roller holder [A] ( x 1)
3. Pick-up roller [B]
4. Paper feed roller [C]
5. Separation roller [D] ( x 1)

Lift, Paper End, and Relay Sensors

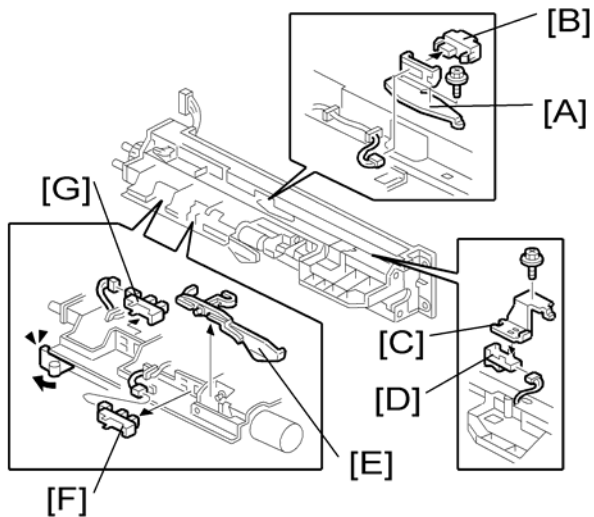

1. Paper feed unit (🖨️ "Paper Feed Unit")
2. Vertical transport sensor bracket [A] (🔩 x 1)
3. Vertical transport sensor [B] (🖨️ x 1)
4. Paper feed sensor bracket [C] (🔩 x 1)
5. Paper feed sensor [D] (🖨️ x 1)
6. Paper end sensor filler [E]
7. Paper end sensor [F] (🖨️ x 1)
8. Lift sensor [G] (🖨️ x 1)

