

**LCIT RT3010**  
**Machine Code: D539**  
**Field Service Manual**

6 August, 2010



# TABLE OF CONTENTS

## 1. Replacement and Adjustment

Covers.....	3
Rear Cover.....	3
Right Door.....	4
Front and Top Covers.....	4
Paper Feed.....	6
Pick-up, Paper Feed and Separation Rollers.....	6
Drive.....	7
Paper Feed Clutch.....	7
Paper Feed Motor.....	7
Tray Lift Motor.....	8
Electrical Components.....	9
Main Board.....	9
LCT Set Switches.....	9
Down Switch.....	10
Paper Feed, Paper End, Tray Lift and Relay Sensors.....	11
Stack Sensor.....	12
Side Fence Position Change.....	14
<b>INDEX</b> .....	17



# 1. Replacement and Adjustment



## Covers

1

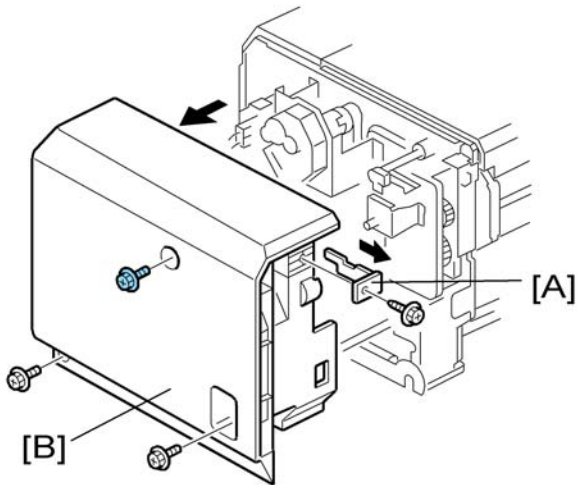
### Rear Cover





d353r102

1. Cover [A] (  x 1)
2. Rear cover [B] (  x 3)

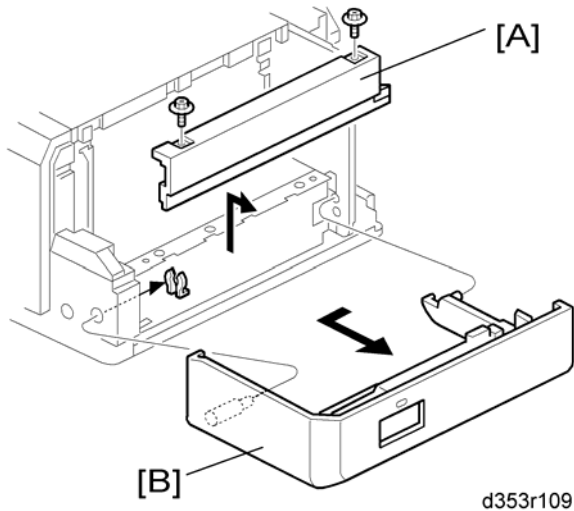
## Right Door





1. Right lower cover [A] (  x 2)
2. Right door [B] (  x 1)

## Front and Top Covers

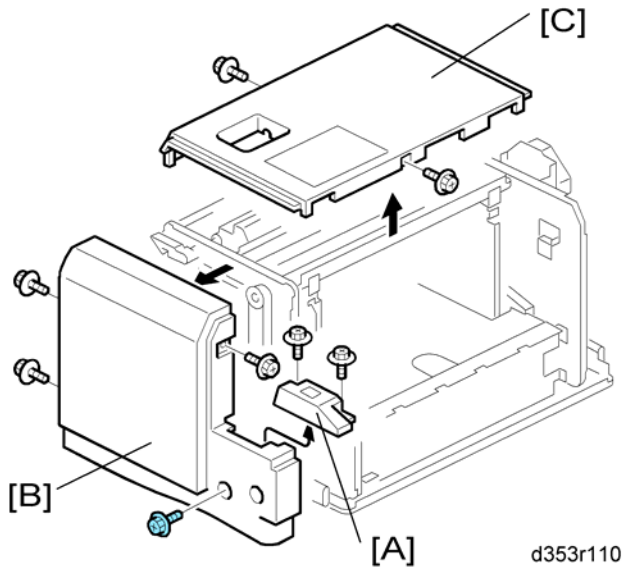
1. Right door (  p.4)



2. Switch cover [A] (  x 2)

3. Front cover [B] (  x 4)
4. Top cover [C] (  x 2)

# Paper Feed

## 1

### Pick-up, Paper Feed and Separation Rollers

1. Open the right door.

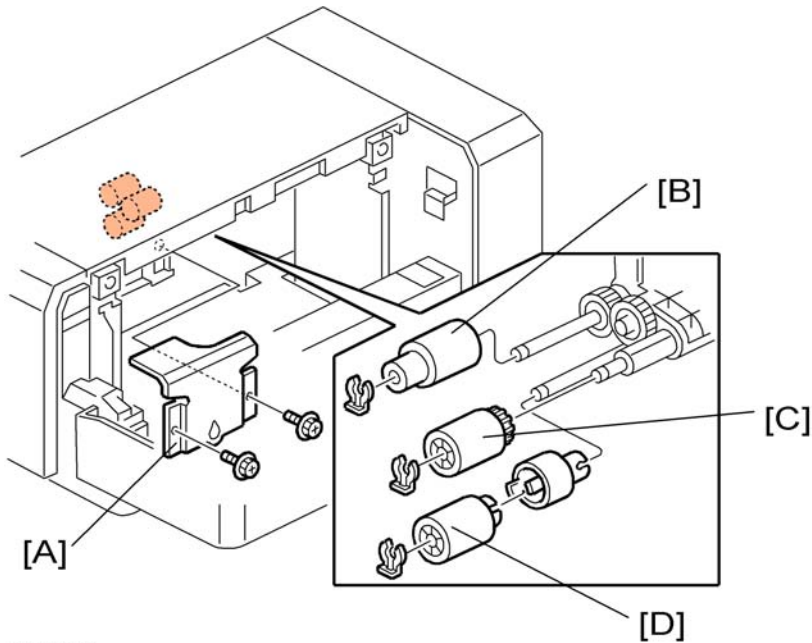

d353r101

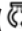
2. Sensor bracket [A] (  x 2)
3. Rollers [B], [C], [D] (  x 1 each)  
[B]: Paper feed roller  
[C]: Pick-up roller  
[D]: Separation roller



# Drive

## Paper Feed Clutch

1

1. Rear cover (p.3)

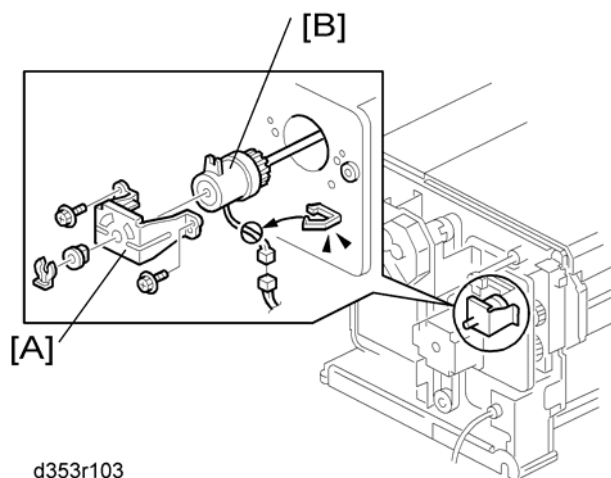

d353r103

2. Bracket [A] (washer x 1, screw x 2, bushing x 1)
3. Paper feed clutch [B] (washer x 1, screw x 1)

## Paper Feed Motor

1. Rear cover (p.3)

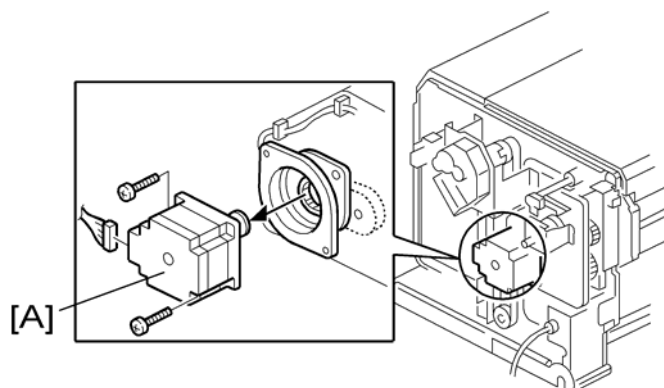

d353r106

1. Paper feed motor [A] (screw x 2)

## Tray Lift Motor

1. Rear cover (🔧 p.3)

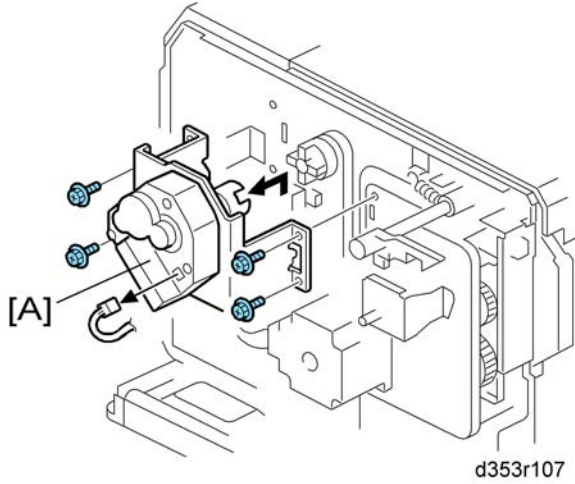

2. Tray lift motor unit [A] (🔧 x 4, 📦 x 1)

# Electrical Components

## Main Board

1

1. Rear cover (🔧 p.3)

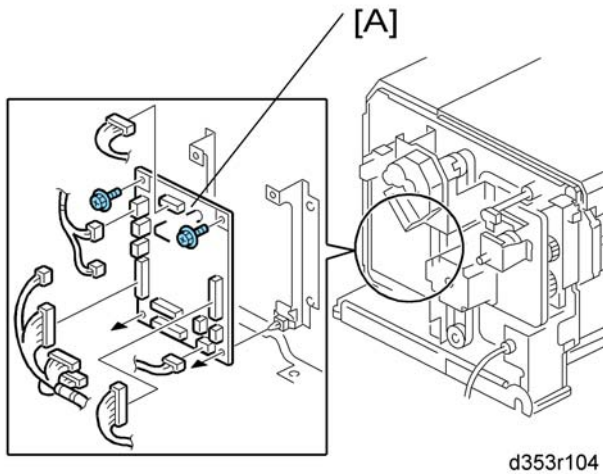

2. Main board (🔧 x 2, all 📦's)

## LCT Set Switches

### Rear

1. Rear cover (🔧 p.3)

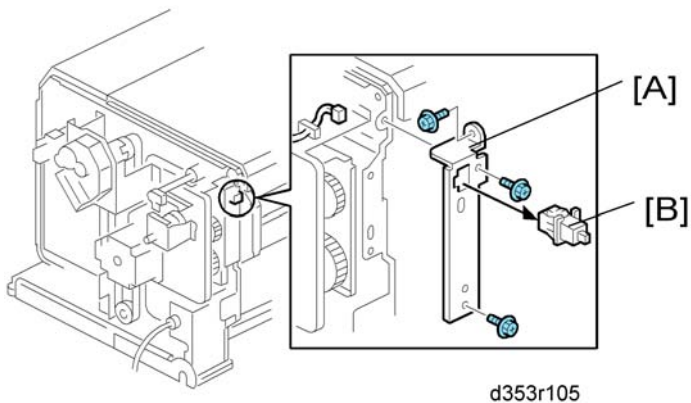

2. Switch bracket [A] (🔧 x 3)

3. Rear LCT set switch [B]

## Front

1. Front cover (p.4)

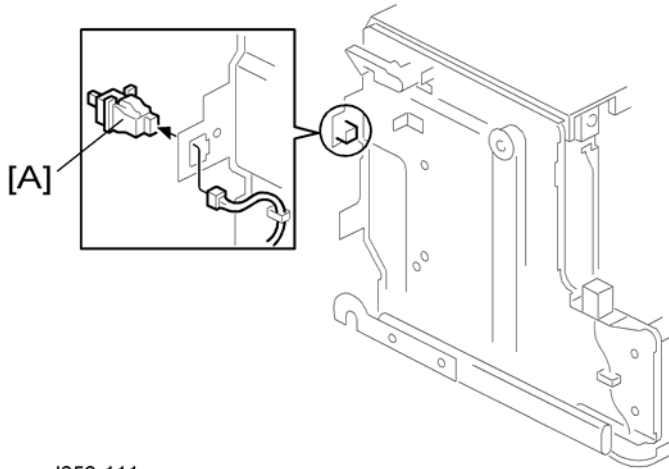

d353r111

2. Front LCT set switch [A] (x 1)

## Down Switch

1. Front cover (p.4)

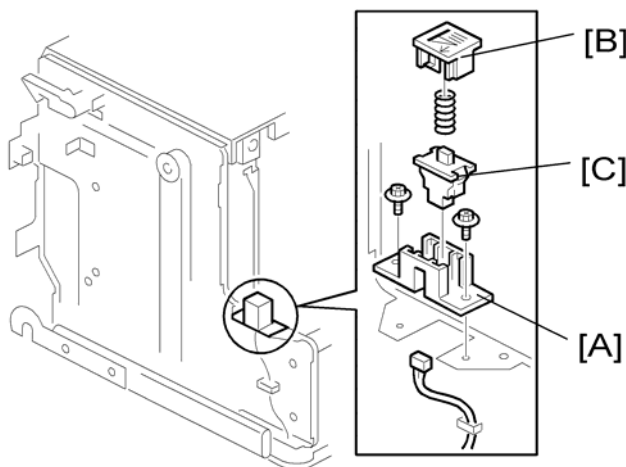

d353r112

2. Switch base [A] (x 2, x 1)
3. Down button [B] (spring x 1)

- Down switch [C] (hook)

## Paper Feed, Paper End, Tray Lift and Relay Sensors

- Front cover (🔩 p.4)
- Top Cover (🔩 p.4)

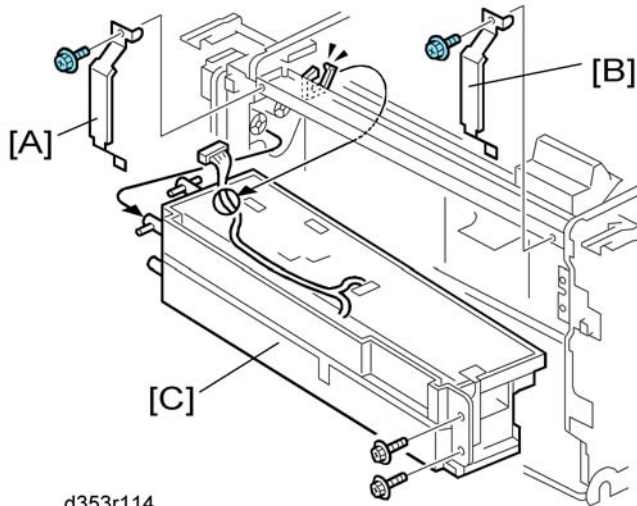

d353r114

- Rear ground plate [A] (🔩 x 1)
- Front ground plate [B] (🔩 x 1)
- Paper feed unit [C] (🔩 x 2, 📄 x 1, 📄 x 1)

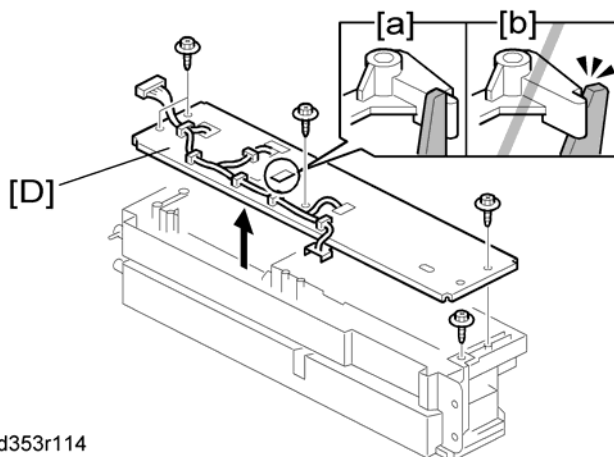

d353r114

- Paper feed unit cover [D] (🔩 x 5, 📄 x 1)

**Note**

- Before you re-install the paper feed unit cover, make sure that the pick-up solenoid holds the pick-up roller lever ([a]: correct, [b]: incorrect) and the pick-up roller works properly.

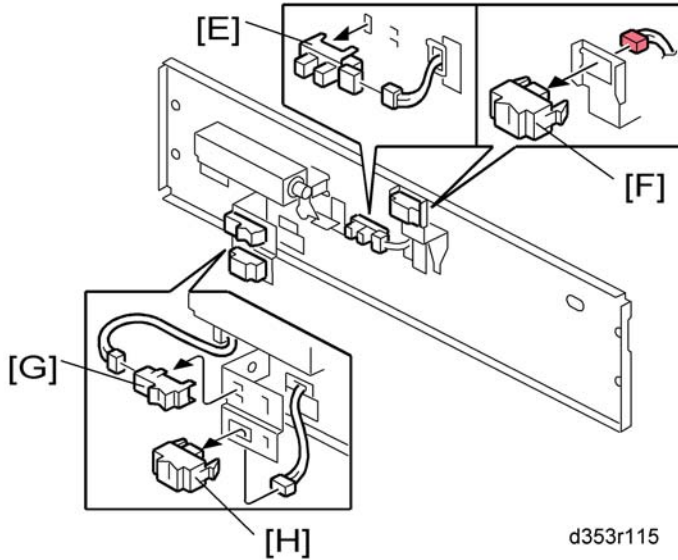

7. Sensors [E], [F], [G], [H] (E x 1, hooks each)

[E]: Tray lift sensor

[F]: Relay sensor



[G]: Paper feed sensor

[H]: Paper end sensor

## Stack Sensor

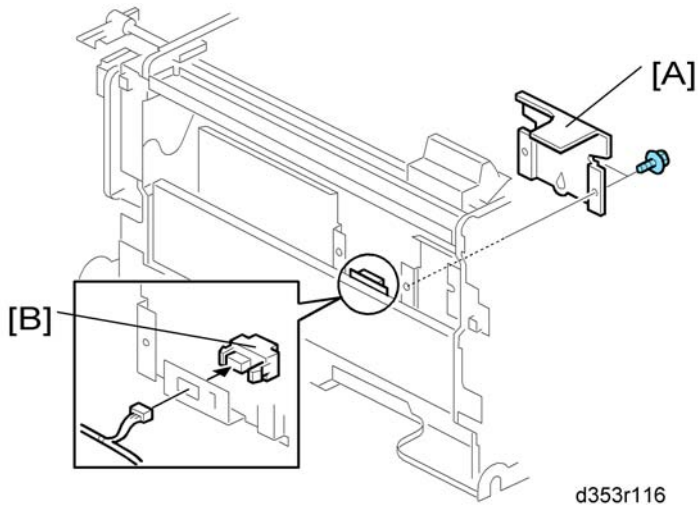
1. Open the right door
2. Paper feed unit (p. 11)



3. Sensor bracket [A] (  x 2)
4. Stack sensor [B] (  x 1)

## Side Fence Position Change

1. Open the right door of the LCT.
2. Push the down switch to lower the tray bottom plate until it reaches its lowest position.

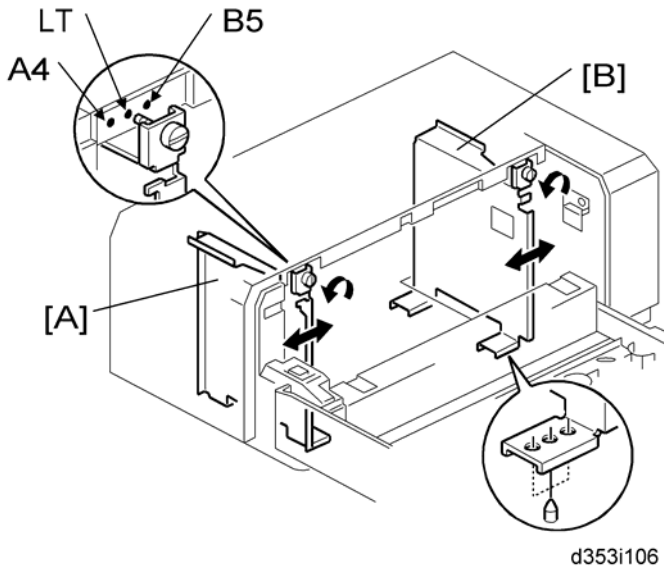

3. Remove the front and rear side fences [A, B] (  x 1 each).
4. Install the side fences in the correct position (A4 LEF/ LT LEF/ B5 LEF).

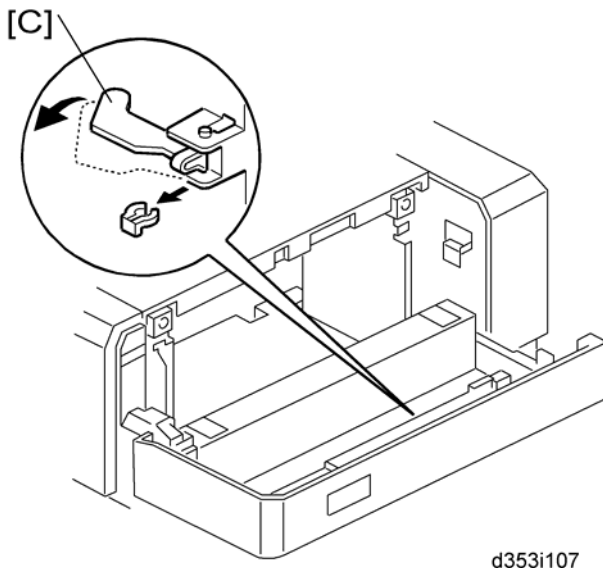



5. Pull the end fence [C] for B5 size paper as shown (  x 1 ) if the the side fences are adjusted for B5 size paper.
6. Close the right door.
7. Turn on the main power switch, and then go into the SP mode.
8. Input the correct paper size for the 1200-sheet LCT with SP5181-017.

